

A PROACTIVE APPROACH TO PROJECT MANAGEMENT



A blue-tinted background image showing a hand in a suit sleeve, gesturing as if conducting an orchestra. The hand is positioned on the left side of the frame, with fingers spread. Another hand is visible in the lower center, holding a baton. The overall image has a monochromatic blue color scheme.

**The Project Manager is
like the Conductor of
an Orchestra, directing
& coordinating efforts
in order to optimize
the results of the
Team.**

The Project Manager is like a Coach of a football team: he establishes the strategy, he selects the stakeholders in line with the Client's objectives.



OUR SERVICES

- PROJECT MANAGEMENT
- PROJECT SUPERVISION
- COST MANAGEMENT
- PROJECT IMPLEMENTATION PLAN
- CLIENT REPRESENTATIVE
- LENDER TECHNICAL ADVISOR
- PROJECT DUE DILIGENCE
- OCCUPIER SERVICES



**Only 16% of Construction
Projects succeed in
meeting scope, time and
cost goals.**

The success of a project is based on :

- **CLEARLY WELL-IDENTIFIED TARGETS**
- **CLEARLY IMPLEMENTATION STRATEGY**
- **EXPERIENCED STAKEHOLDERS**
- **A PROFESSIONAL MANAGEMENT**
- **A SOUND MANAGEMENT**

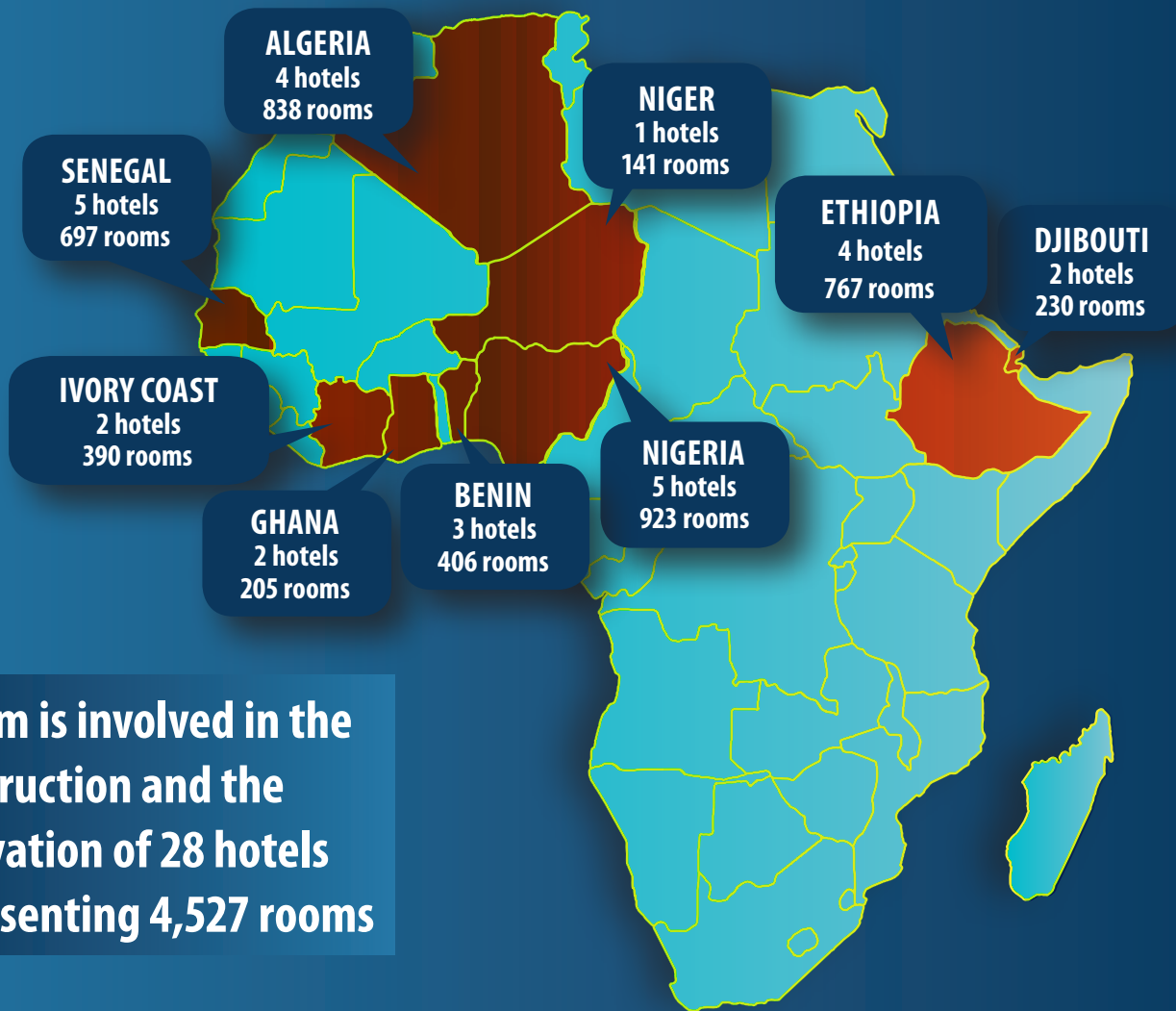

Gassim is involved in the construction and the renovation of 28 hotels representing 4,527 rooms



Akwaba Hotel - Ivory Coast
Project Management



Conference Centre - Benin
Project Management

Hyatt Hotel - Nigeria
Project Management

Softel Hotel - Benin
Project Management





Mercure Africana - Algeria
Technical Advisor



Capital Hotel - Ethiopia
Project Implementation Plan



Grand Resort - Ethiopia
Project Implementation Plan

Sheraton - Senegal
Construction Management

Aloft Hotel - Senegal
Construction Management





Viceroy Hotel & Residence – UAE
Structural Value Engineering



Corinthia Hotel - Sudan
Construction Management

Radisson Blu Hotel - Georgia
Client Advisor

2 février Hotel - Togo
Project Management





Khalidiya Hotel - UAE
Structural Value Engineering



Coral Radisson Cabo Verde Hotel
Project Management



Acacias Hotel - Djibouti
Project Implementation Plan

Hilton Hotel - Malabo
Construction Management

Plein Ciel Hotel - Djibouti
Project Implementation Plan





Noom Hotel - Niger
Lender Technical Advisor

Sofitel Hotel - Malabo
Client Representative



Viceroy Palm Jumeirah Hotel - Dubai
Structural Value Engineering

Transcorp Hilton Hotel - Nigeria
Project Management





Ibis Airport Hotel - Algeria

Client Assistant



Novotel Hotel - Algeria

Client Assistant

Ibis Hotel Mostaganem - Algeria

Client Assistant

Pullman Hotel - Ethiopia

Project Management





Arena Mall - Romania
Construction Management



Magnolia Park - Poland
Construction Management



Discovery Gardens - UAE
Structural Value Engineering

Royal Atlantis Palm - UAE
Structural Value Engineering

Plaza Views - UAE
Structural Value Engineering





Mag 5 Boulevard - UAE

Structural Value Engineering

Shopping Mall - Georgia

Construction Management



Parking Education City - Qatar

Structural Value Engineering

Emirates Headquarter - UAE

Structural Value Engineering



Entisar Tower - UAE

Structural Value Engineering

Sabic Headquarter - Saudi Arabia

Construction Management





Hafr Al Batin Hospital - Saudi Arabia

Construction Management



St. Amand Hospital - France

Construction Management



Gurayat Hospital - Saudi Arabia

Construction Management

Khafji Hospital - Saudi Arabia

Construction Management

Rafha Hospital - Saudi Arabia

Construction Management





Longjumeau Hospital - France

Construction Management

Al Ain Hospital- Abu Dhabi

Value Engineering



Buraidah Hospital - Saudi Arabia

Construction Management

Khalifa Hospital - Abu Dhabi

Contract Management



Châteaudun Hospital- France

Construction Management

Dreux Hospital - France

Construction Management



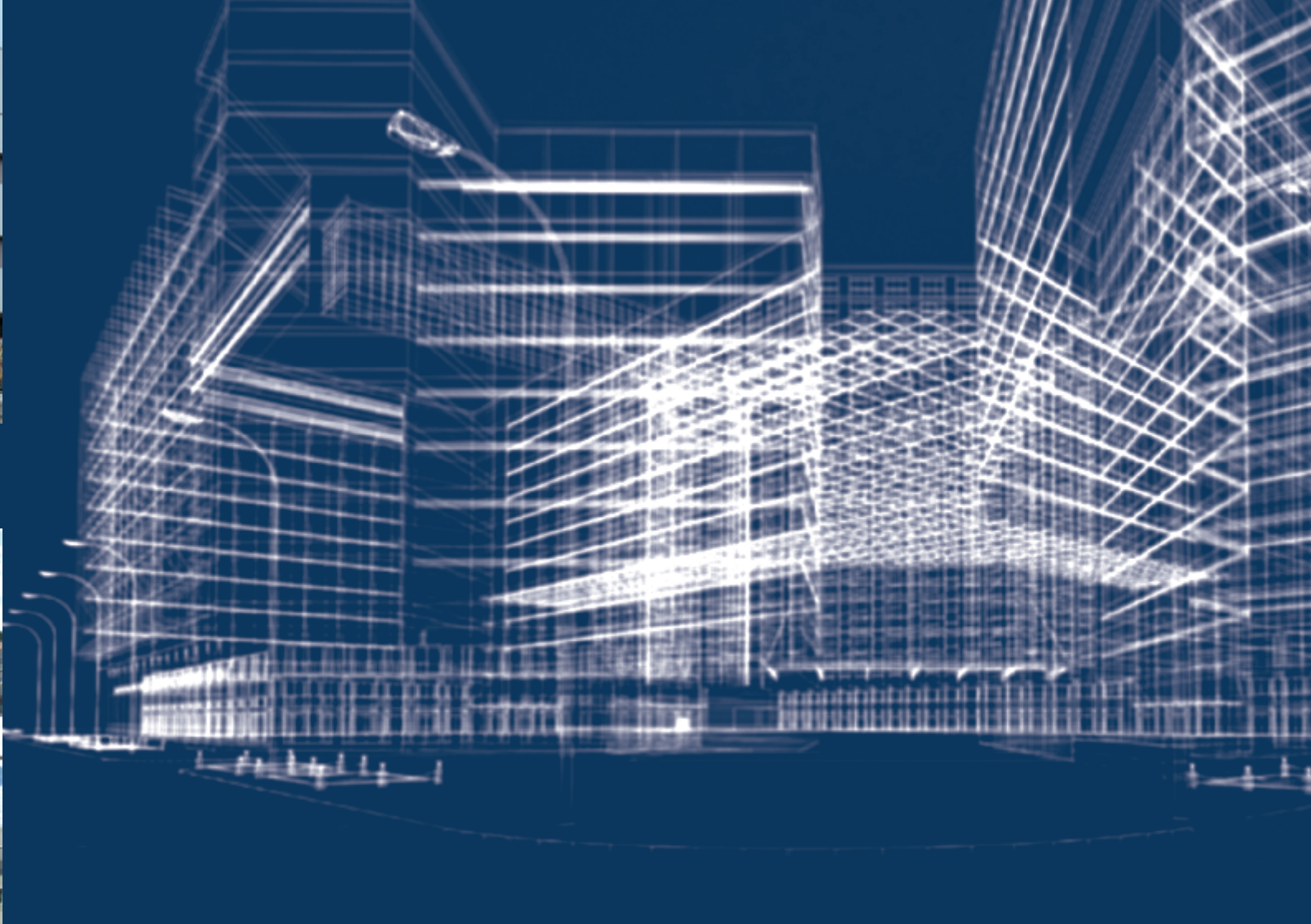

www.gassim.eu

contact@gassim.eu



 Gassim Pm

 Gassim Pm